

GX6 & GXC6

150mm (6") AC axial extract fans



Models

GX6 **Ref. 90800AW**
Single speed extract fan | Operated by a remote switch or sensor (not supplied)

GX6T **Ref. 90812AW**
Single speed extract fan | Integral run-on timer, adjustable from 2-20 mins, operated by lighting circuit

GX6HT **Ref. 90814AW**
Single speed extract fan | Integral automatic humidistat operation adjustable between 50-90% RH | Integral run-on timer operated by the lighting circuit | Timer adjustable from 2-20 mins

GX6HT2 **Ref. 90863AW**
Two speeds and humidistat or manual control selectable using an Xpelair TBS control (not supplied) | Silent electro-thermal shutter | Automatic humidistat operation adjustable between 50-90% RH | Integral run-on timer operated by room lighting circuit | Timer adjustable from 2-20 mins

GXC6 **Ref. 90850AW**
Single speed extract fan | Integral pullcord switches fan on and opens shutter

GX6 (SAUDI) **Ref. 90806AW**

GXC6 (SAUDI) **Ref. 90856AW**

The Range

Xpelair GX models are purpose designed for use in kitchens and utility rooms and can be window or panel mounted as supplied, or wall mounted using an optional wall kit.

GXC models have an integral pullcord actuator. Timer and humidistat versions are also available, along with multi-speed models. A trickle ventilation facility is available for background ventilation when not in use.

Key Features

- **Single and two speed axial extract fans**
- **Two speed model operation requires COS switch accessory**
- **GX models remotely switched with silent electro-thermal actuated shutter**
- **GXC pullcord operated with mechanical louvred backdraught shutter**
- **Lubricated for life motor with thermal cut-out protection**
- **Clip-off front cover for ease of cleaning**
- **220/240V 50-60Hz**

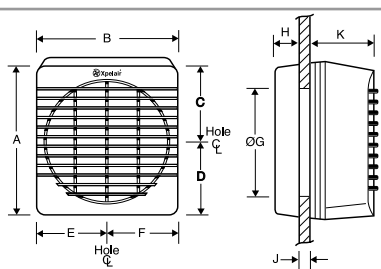

Dimensions (mm)

A	B	C	D	E	F	øG	H	J	K
226	210	119	107	109	101	184/203	32	4-35	113

Product Selector	GX6	GX6T	GX6HT	GX6HT2	GXC6	GX6 (SAUDI)	GXC6 (SAUDI)
Reference number	90800AW	90812AW	90814AW	90863AW	90850AW	90806AW	90856AW
Speeds	1	1	1	2	1	-	-
Extract performance (FID, m ³ /h)	266	266	266	Max 266, Min 222	266	-	-
Extract performance (FID, l/s)	74	74	74	Max 74, Min 62	74	-	-
Extract performance (CFTmin)	156.8	156.8	156.8	Max 156.8 Min 131.4	156.8	-	-
Sound pressure level (dB(A)@3m)	37	37	37	Max 37, Min 34	37	-	-
Electrical power rating (W)	30	30	30	30	30	-	-
Hole diameter (mm)	184	184	184	184	184	-	-
Hole diameter with wall liner (mm)	203	203	203	203	203	-	-
Weight (kg)	1.9	1.9	1.9	1.9	1.9	-	-